

# AERODROME CHART

TWR01 118.8(118.325) for RWY17L/35R, 17R/35L  
 TWR02 118.4(118.725) for RWY16L/34R, 16R/34L  
 TWR03 124.35(118.325) for RWY17L/35R  
 TWR04 118.575(118.725) for RWY16R/34L

APN01: 121.65(122.125)  
 APN02: 121.975(122.125)  
 APN03: 122.7(122.125)  
 APN04: 122.6(122.125)

GND01: 121.7  
 GND02: 121.8  
 GND03: 121.875  
 GND04: 121.625  
 Delivery: 121.95(121.625)(DCL AVBL) N31° 08.7'E121° 47.6' ELEV 3.8m

## ZSPD SHANGHAI/Pudong

BEARINGS ARE MAGNETIC.  
 ALTITUDES, DISTANCES,  
 ELEVATIONS AND HEIGHTS  
 IN METERS.

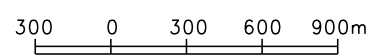
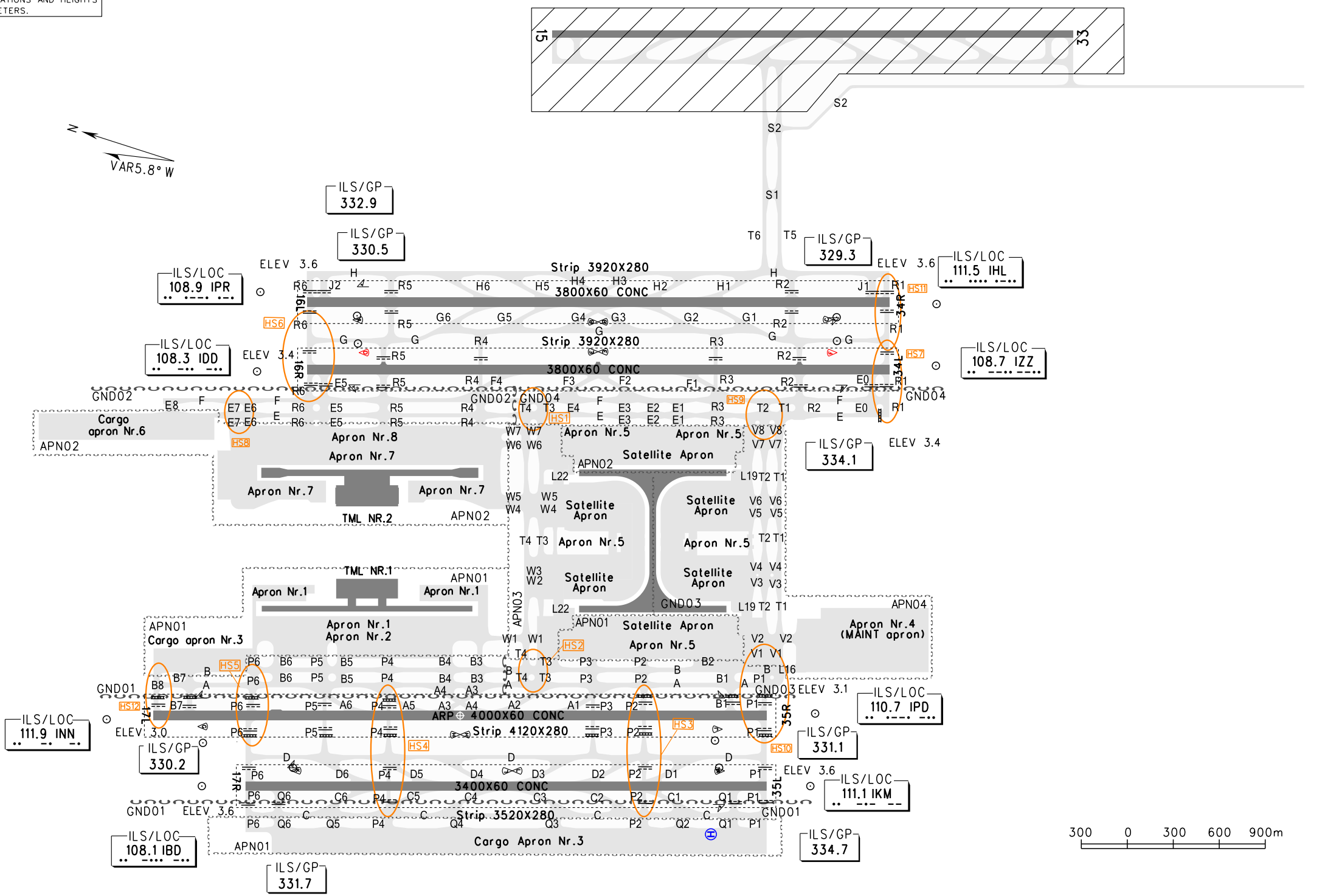
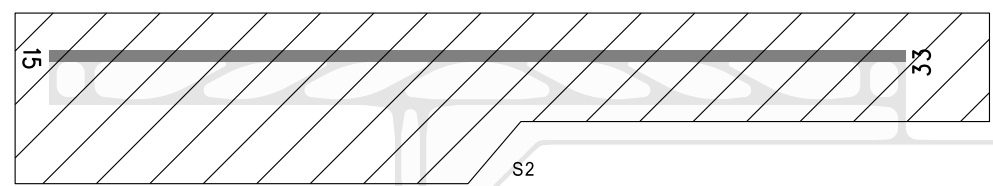

**Legend:**

- HS1-HS12: Hot spot.
- H: Helicopter take off and landing area
- ▨: Construction area.

ACFT Type	TAKE-OFF MINIMA(WITH RELIABLE ALTN)(m)				LIGHTS		
	LVP in force 17L/35R/34L		RWY16L/34R,16R/34L 17L/35R,17R/35L		16L/34R, 17R/35L	17L/35R, 16R/34L	
	REDL&RCLL&RVRS	REDL&RCLL	REDL&RCLM	NIL(Day only)	PALS CAT I SFL PAPI REDL RCLL RENL	PALS CAT II/III SFL PAPI REDL RCLL RTZL RENL	
2 TURB ENG or 3&4 ENG	A	RVR150	RVR200	RVR400	RVR500		
	B			VIS800	VIS800		
	C						
	D	RVR200	RVR250				

Changes: Location of RVR.