

AIRCRAFT PARKING DOCKING CHART

Bearings are magnetic Distances in metres Elevation in ft AMSL Coordinates WGS 84	TWR 118.250	AD ELEV 95	REGGIO CALABRIA		
		APRON ELEV 57	L I C R	38°04'19" N	015°39'13" E

APRON 1 (Main Apron)		APRON 2 (GEN AV)		APRON 3 (GEN AV)	
lighting	bearing strength	lighting	bearing strength	lighting	bearing strength
Edge: Blue	PCN 55/R/D/W/T	Edge: Blue	PCN 24/F/C/W/T	Nil	PCN 10I/F/A/W/T

POINTS ON PARKING AREA

STANDS	N	E	STANDS	N	E
101	38°04'26.53"	15°39'09.84"	201	38°04'27.72"	15°39'04.20"
102	38°04'24.68"	15°39'11.06"	202	38°04'26.44"	15°39'05.05"
103	38°04'22.84"	15°39'12.29"	203	38°04'25.14"	15°39'05.91"
104	38°04'20.99"	15°39'13.50"	301	38°04'32.58"	15°38'59.70"
105	38°04'19.58"	15°39'15.02"	302	38°04'33.54"	15°38'59.09"
106	38°04'18.89"	15°39'16.55"	303	38°04'34.45"	15°38'58.44"
			304	38°04'35.42"	15°38'57.89"

CHANGE: Magnetic variation/Annual change

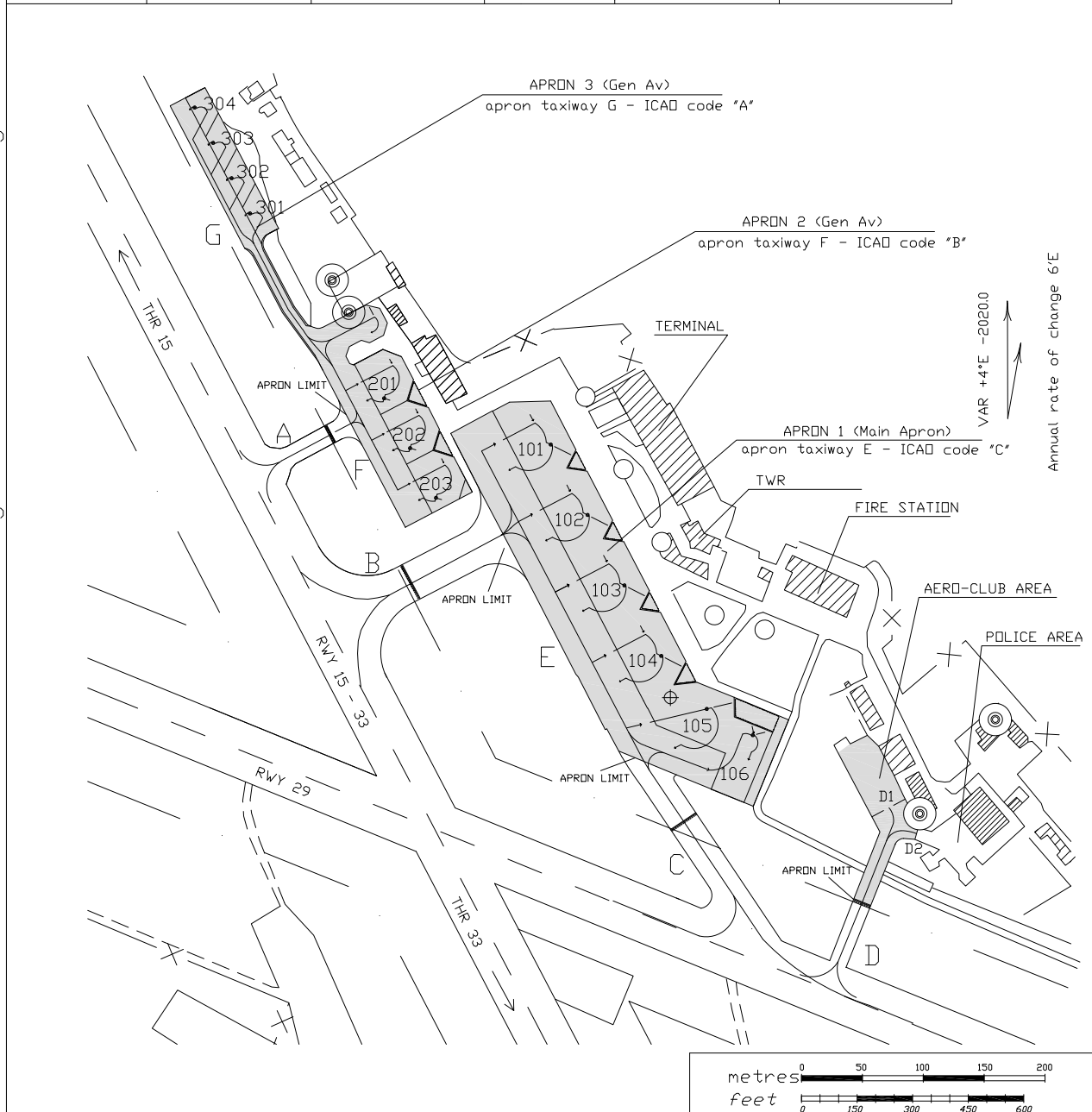

Data provided by S.A.CAL. S.p.A.