

AIRCRAFT PARKING /
DOCKING CHART - ICAO

APRON ELEV

APP	119.7	349.5
TWR	118.7	237.6
SMC	121.9	335.3
ATIS	127.05	

TAIF/Taif International

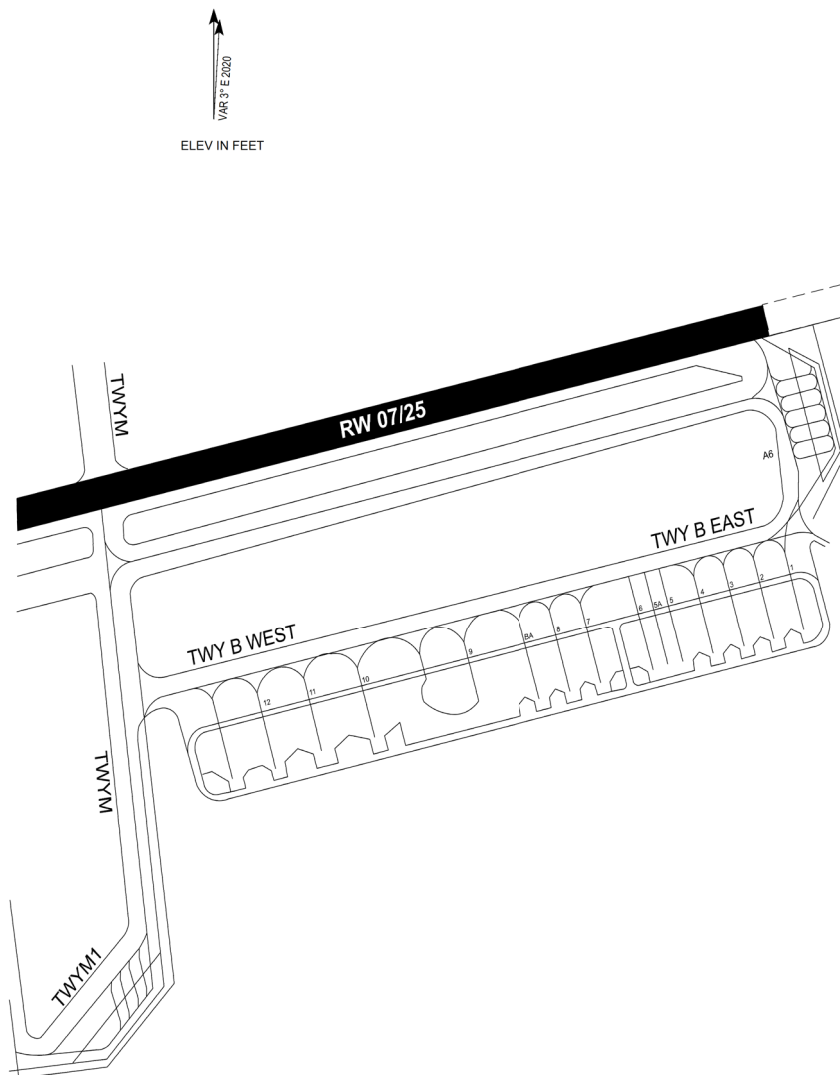

INS COORDINATES FOR ACFT STANDS ON APRON 8		
BAY 01	21°28'55.84"N	040°33'22.01"E
BAY 02	21°28'55.46"N	040°33'20.53"E
BAY 03	21°28'55.09"N	040°33'19.07"E
BAY 04	21°28'54.71"N	040°33'17.61"E
BAY 05	21°28'54.33"N	040°33'16.17"E
BAY 05A	21°28'54.15"N	040°33'15.44"E
BAY 06	21°28'53.96"N	040°33'14.71"E
BAY 07	21°28'53.31"N	040°33'12.13"E
BAY 08A	21°28'52.53"N	040°33'09.16"E
BAY 08	21°28'52.92"N	040°33'10.65"E
BAY 09	21°28'52.46"N	040°33'06.17"E
BAY 10	21°28'50.63"N	040°33'01.17"E
BAY 11	21°28'49.97"N	040°32'58.60"E
BAY 12	21°28'49.23"N	040°32'56.35"E

NOTES:

- 1) THE CIVIL APRON AT TAIF INTERNATIONAL AIRPORT HAS A TOTAL OF FOURTEEN (14) PARKING STANDS WITH THIRTEEN PARKING STANDS (PARKING STAND NO.1 TO 8A AND 10 TO 12) FOR CIVILIAN AIRCRAFT PARKING AND ONE PARKING STAND (PARKING STAND NO.9) EXCLUSIVELEY FOR ROYAL/VIP PARKING.
- 2) ALL PARKING STANDS EXCEPT PARKING STAND NO.9 REQUIRE POWER-IN PUSH-OUT (NOSE-IN) OPERATIONS.
- 3) PARKING STANDS NO.9 HAS A POWER-IN,POWER-OUT OPERATIONAL CAPABILITY.
- 4) COMMERCIAL AIRCRAFTS ARE NOT ALLOWED TO PARK STAND NO.9 WITHOUT PRIOR APPROVAL FROM CONCERNED AUTHORITIES RESPONSIBLE FOR OETF AIRPORT OPERATIONS.
- 5) PARKING STANDS ARE MARKED NUMERICALLY FROM 1 TO 12 FROM EAST TO WEST WITH THE VIP PARKING STAND MARKED AS 9.
- 6) PARKING STANDS NO.1 TO 8A AND 12 CAN ACCOMMODATE ICAO AERODROME REFERENCE CODE "C" AND SMALLER AIRCRAFTS WITH THE MAXIMUM AIRCRAFT TYPE BEING AIRBUS A-321 IN TERMS OF LENGTH AND BOEING B737-800 IN TERMS OF WINGSPAN.
- 7) PARKING STAND NO.5A NO.10 AND 11 CAN ACCOMMODATE ICAO AERODROME REFERENCE CODE "E" AND SMALLER AIRCRAFTS WITH THE MAXIMUM AIRCRAFT TYPE BEING BOEING 777-300 ER IN TERMS OF LENGTH AND BOEING 747-400 IN TERMS OF WINGSPAN.
- 8) THE STOP BARS AT PARKING STANDS 1 TO 8A AND 12 ARE MARKED FOR E-170, MD90, A320 AND BOEING 737 AIRCRAFTS.
- 9) THERE ARE TWO STOP BARS AT PARKING STANDS NO.5A, NO. 10 AND 11. THE FIRST STOP BAR IS MARKED FOR E-170, MD90, A320 AND B-737 AIRCRAFTS, WHEREAS THE SECOND STOP BAR (NEAREST TO THE TERMINAL) IS MARKED FOR A-330, B-747 AND B-777 AIRCRAFTS.
- 10) PARKING STAND 8A IS NOT TO BE USED WHEN AIRCRAFT IS APPROACHING OR PARKED AT PARKING STAND 9.
- 11) IN CASE OF USING AIRCRAFT STAND NO.5A AIRCRAFT STAND NO. 5 AND 6 ARE UNSERVICEABLE.
- 12) IN CASE OF USING ONE OF AIRCRAFT STANDS NO. 5 OR 6 AIRCRAFT STAND NO. 5A IS UNSERVICEABLE.
- 13) APRON SURFACE: CONCRETE/ASPHALT, STRENGTH: 54/R/B/X/T, EXCEPT STANDS 5, 5A, AND 6 STRENGTH : 139/R/C/W/T

CHANGE: Stand 5A added, Stand 13 deleted