

AERODROME GROUND
MOVEMENT CHART - ICAO

APRON ELEV
101 m

LISBOA ARR INFORMATION 124.155
LISBOA DEP INFORMATION 121.955

LISBOA DELIVERY 118.955
LISBOA GROUND 121.755
LISBOA TOWER 118.105

LISBOA, Humberto Delgado (LPPT)

TAXI ROUTE PROCEDURES
ARRIVAL / DEPARTURE RWY 02

VAR 02° W 2020
ANNUAL CHANGE 10' E

HOTSPOT

TAXIWAY
CAUTION !
RUNWAY

ARRIVAL RWY 02
- Pilots should plan their landing to vacate RWY 02 via TWY "H4", in order to minimize runway occupancy time, except by agreement of ATC.
- If, for any particular reason, you wish to vacate via taxiway "A6" or "T5", make the request on first contact with TWR.

Hot Spot 9:
CAUTION - Do not cross/enter
RWY 02/20 without ATC Clearance
on TWR FREQ

Hot Spot 10:
Holding Point RWY 20

Hot Spot 7:
Frequent traffic taxiing on TWY Q -
CAUTION intersection with TWY W

Hot Spot 8:
Frequent traffic taxiing on TWY A (main apron) -
CAUTION intersection with TWY W

Hot Spot 5:
Frequent traffic taxiing on TWY Q -
CAUTION intersection with TWY G

Hot Spot 4:
Frequent traffic taxiing on TWY A (main apron) -
CAUTION intersection with TWY G

Hot Spot 2:
Frequent traffic taxiing from
TWY L and along TWY M.

Hot Spot 1:
Frequent traffic taxiing from
TWY Q1 and along TWY M.

IN ORDER TO AVOID JET BLAST HAZARDS,
IF NOT CLEARED TO CROSS/ENTER
TWY "T", AIRCRAFT SHALL STOP AND HOLD
PARALLEL WITH TWY "T" BEFORE
TWY "G1", "Y", "M1" OR "K".

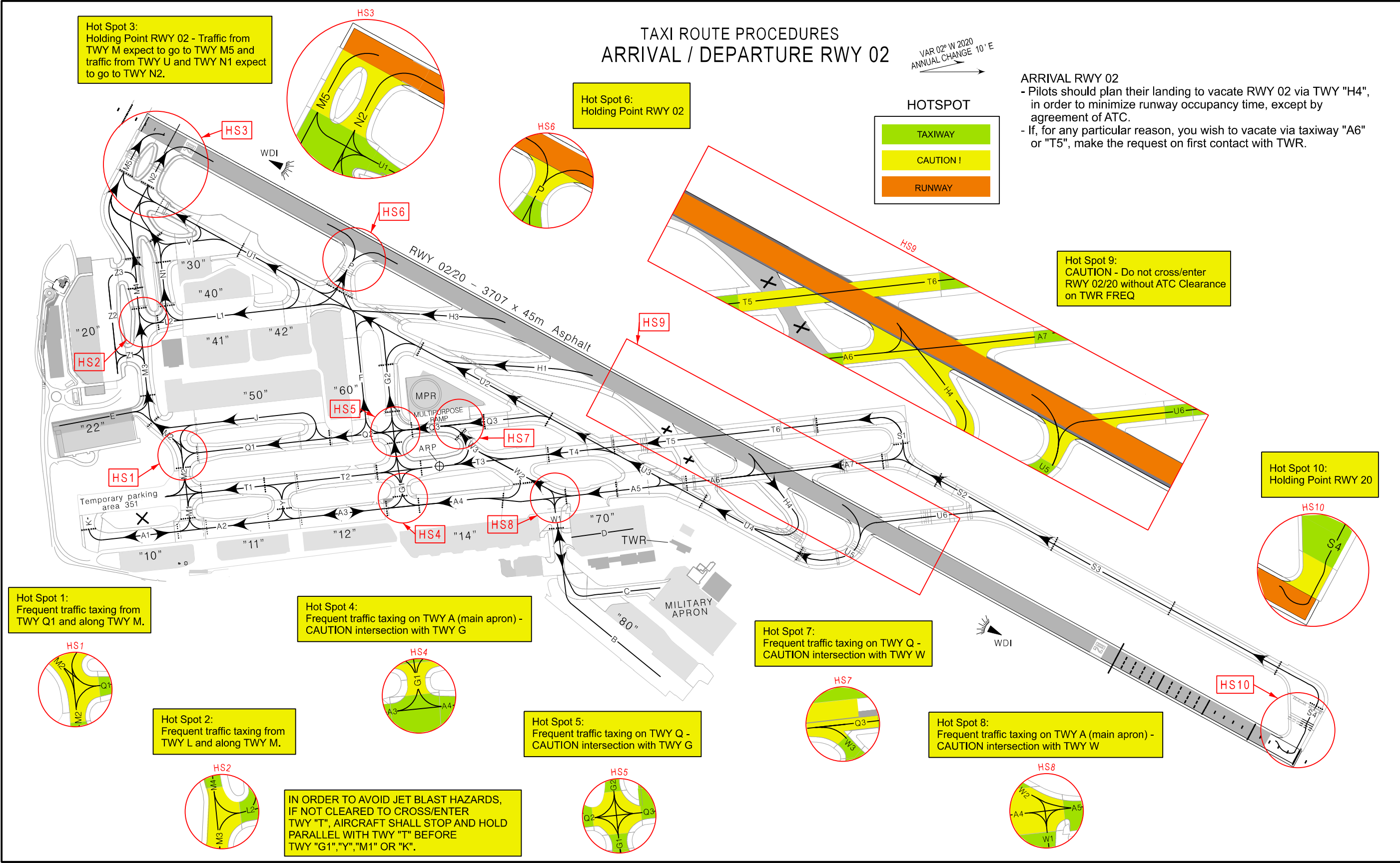

THIS PAGE INTENTIONALLY LEFT BLANK