

**AERODROME GROUND  
MOVEMENT AND AIRCRAFT  
PARKING/DOCKING CHART - ICAO**

**SANKT-PETERBURG, RUSSIA**

**PULKOVO**

APRON	120.900	GROUND	121.700	TOWER	133.500	In CTR 1 during VFR flights.
RAMP	119.000	TOWER RWY 10R/28L	118.700			
DELIVERY	121.900	TOWER RWY 10L/28R	118.100			

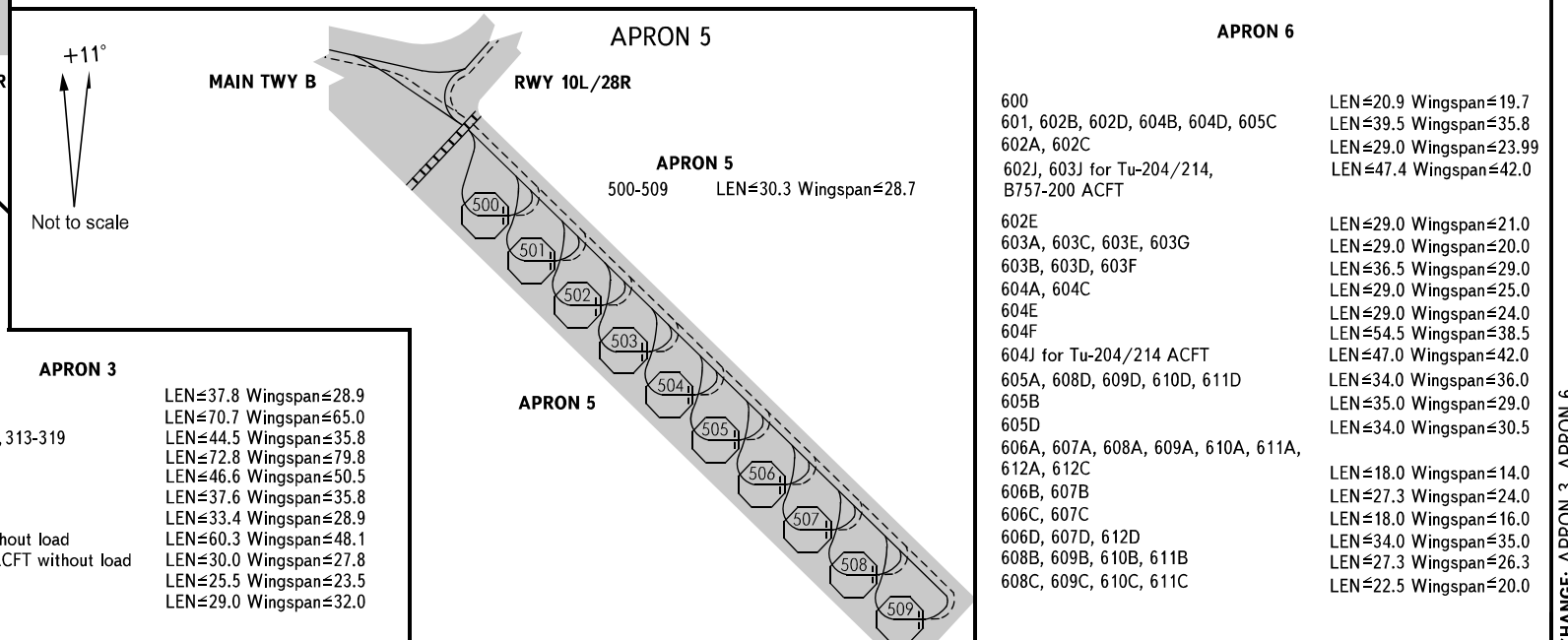
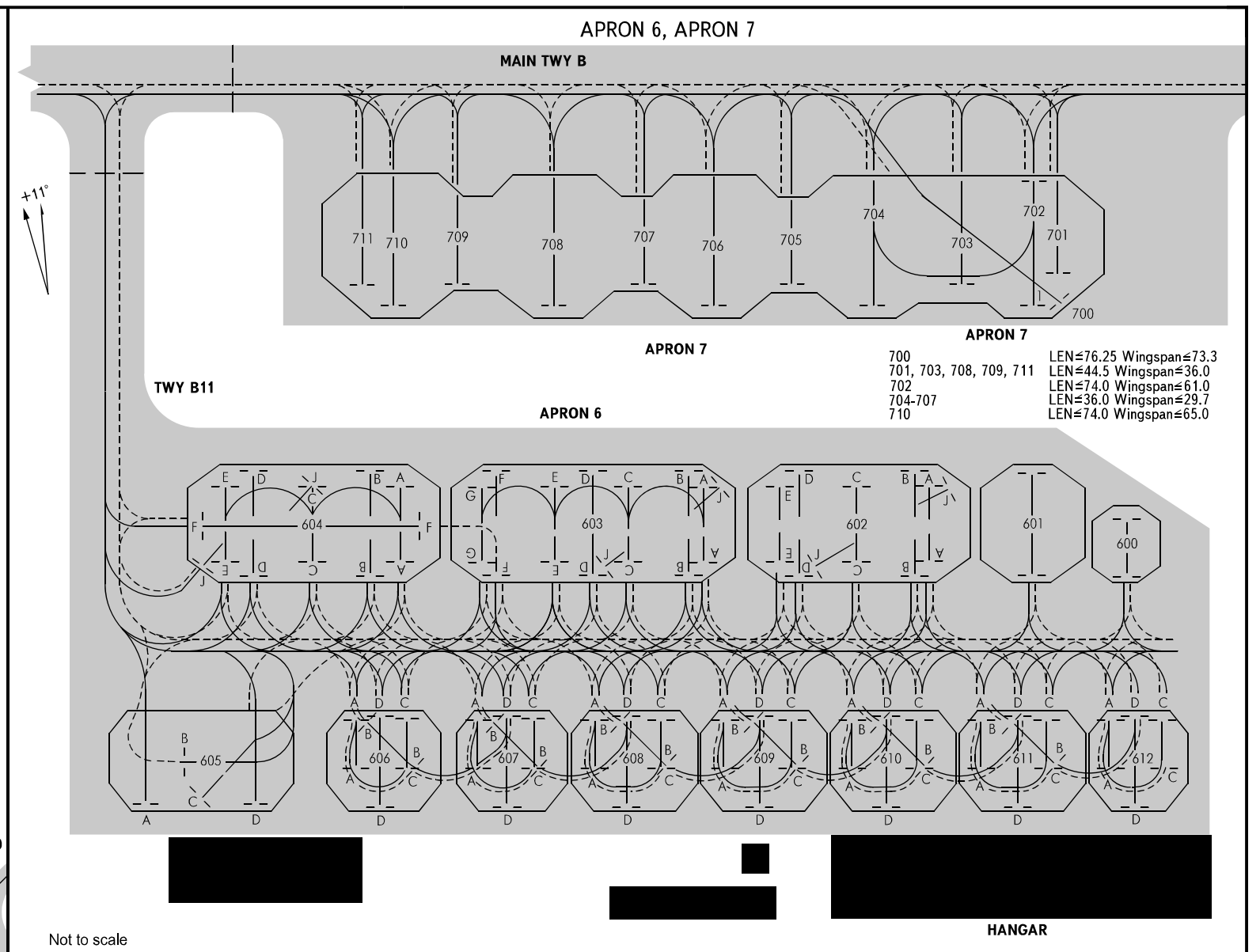
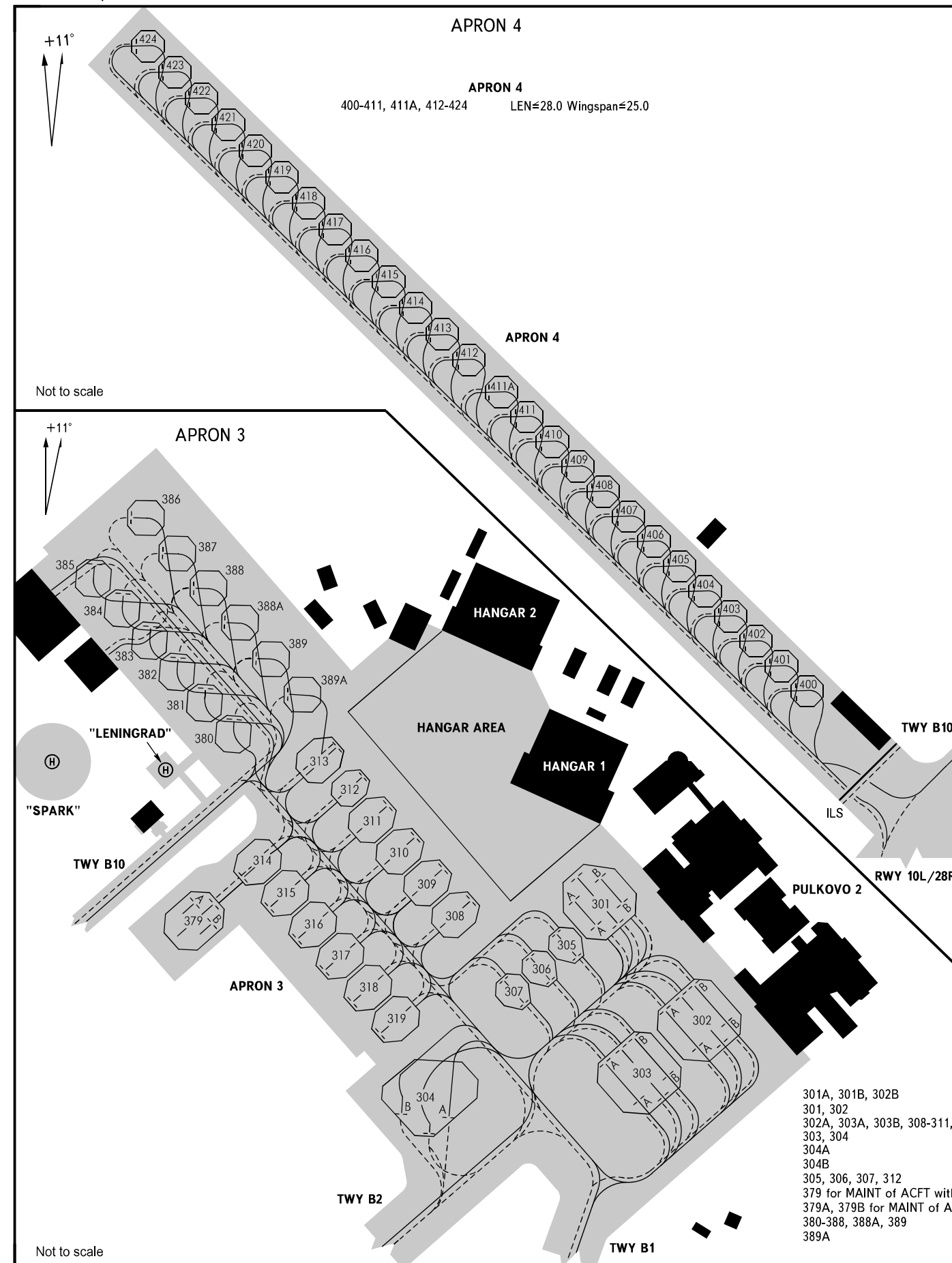

CHANGE: APRON 3, APRON 6

**AIRCRAFT PARKING****SANKT-PETERBURG, RUSSIA****PULKOVO****APRON 1 stands:**

1. ACFT shall taxi into stands 101, 101A, 101B, 102, 102A, 102B, 103, 103A, 103B, 104, 104A, 104B, 105, 105A, 105B, 106, 106A, 106B, 107, 107A, 107B, 108, 108A, 108B, 109, 109A, 109B, 150A, 150B, 151 under own engines power; taxi out – under tow; ACFT shall taxi into stands 150, 152, 152A, 152B, 153, 153A, 153B, 154, 154A, 154B, 155, 155A, 155B, 156, 156A, 156B facing north-west under own engines power; taxi out - under tow.
2. ACFT shall taxi into/out of stands 130, 130A, 130B, 131, 132, 133, 134, 135, 136, 137, 138, 139, 140, 141, 142, 143, 144, 145, 146, 146A, 146B under own engines power.
3. ACFT shall be parked onto stands 150, 152, 152A, 152B, 153, 153A, 153B, 154, 154A, 154B, 155, 155A, 155B, 156, 156A, 156B facing south-east under tow; taxi out - under own engines power.
4. ACFT shall taxi into stand 101C under own engines power after the "Follow-me" vehicle through vacant stand 101A, when stands 101, 101B are vacant; taxi out - under own engines power after the "Follow-me" vehicle through vacant stand 101B.
5. Stands 102A, 103A, 104A, 105A, 107A, 108A are AVBL for parking of ACFT with wingspan over 35.0 m, but not above 36.0 m, ACFT shall taxi in under own engines power, taxi out - under tow, at the same time it is PROHOBITED for ACFT with wingspan over 34.1 m, but not exceeding 36.0 m to simultaneously taxi in/taxi out of stands 102B, 103B, 104B, 105B, 107B, 108B.
6. Stands 102B, 103B, 104B, 105B, 107B, 108B are AVBL for parking of ACFT with wingspan over 35.0 m, but not exceeding 36.0 m:
  - ACFT shall taxi in under own engines power, taxi out under tow, when stands 102A, 103A, 104A, 105A, 107A, 108A are simultaneously occupied by ACFT with wingspan 34.1 m or less;
  - ACFT shall taxi in/taxi out of stands under tow, when stands 102A, 103A, 104A, 105A, 107A, 108A are simultaneously occupied by ACFT with wingspan over 34.1 m, but not exceeding 36.0 m.
7. Simultaneous taxi in/taxi out operations of two ACFT with wingspan over 35.0 m into/out of stands 102, 103, 104, 105, 107, 108 are PROHIBITED.
8. ACFT with wingspan 36 m or less shall taxi into stands 138, 141, 143, 145 under own engines power facing south-east, taxi out - under own engines power as follows:
  - from stands 138, 141, 143, 145 to Route E towards MAIN TWY A only, when stands 137, 140, 142, 144 are vacant respectively;
  - from stands 138, 145 to Route E towards MAIN TWY B, no restrictions imposed;
  - from stands 141, 143 to Route E towards MAIN TWY B only, when stands 142, 144 are vacant respectively;
  - from stands 138, 141, 143, 145 to Routes C, D, no restrictions imposed.
9. Through taxiing via Route D is permitted for ACFT with wingspan 80 m or less, via Route F for ACFT with wingspan 65 m or less, via Routes C and E (simultaneous taxiing) for ACFT with wingspan 36 m or less.
10. Through taxiing of ACFT with wingspan not exceeding the wingspan limit on relevant stands and taxi routes is permitted after the "Follow me" vehicle:

- through vacant stand 130 (when stands 130A, 130B are vacant) from Route F to Routes D and C and in the opposite direction from Route D to Route F only;
- through vacant stand 146 (when stands 146A, 146B are vacant) from Route F to Routes D and C and in the opposite direction;
- through vacant stands 130A, 130B (when stand 130 is vacant) from Route F to Routes E, D and C and in the opposite direction from Routes E and D to Route F only;
- through vacant stands 146A, 146B (when stand 146 is vacant) from Route F to Routes E and C and in the opposite direction;
- through vacant stands 137, 141 from Route F to Routes E, D, C and in the opposite direction;
- through Route D from Route C to Route E and in the opposite direction strictly along the established ACFT taxi guide lines.

11. Through taxiing of ACFT is permitted:
  - through stands 130A, 137, 141, 146A to Route E towards MAIN TWY A only, when stands 130B, 136, 140, 146B are vacant respectively;
  - through stands 130B, 137, 141, 146B to Route E towards MAIN TWY B only, when stands 130A, 138, 142, 146A are vacant respectively.
12. Simultaneous taxi/tow operations (same direction/opposite direction traffic) via Routes C, D and via Routes D, E are PROHIBITED.

**APRON 2 stands:**

1. Through taxiing on the apron under own engines power is permitted for ACFT with wingspan 34.1 m or less.
2. ACFT with wingspan 34.1 m - 42.0 m shall taxi on the apron from TWY B8 and TWY B9 under tow only.
3. Taxiing into/out of stands 252, 253, 254, 255, 256, 257, 258, 259, 260 - under tow.
4. ACFT with length over 30.0 m and wingspan over 30.0 m shall taxi into/out of stands 261, 262, 263 under tow only.
5. ACFT with length 30.0 m or less and wingspan 30.0 m or less shall taxi into stands 261, 262, 263 under own engines power through vacant stand with smaller number. During taxiing of ACFT into stand 261 under own engines power, stand 260 must be vacant, during taxiing of ACFT into stand 262 under own engines power, stand 261 must be vacant, during taxiing of ACFT into stand 263 under own engines power, stand 262 must be vacant. Taxiing out of these stands - under own engines power.
6. Taxiing into/out of stands 257, 258, 259, 260 under own engines power is permitted for HEL with length 14 m or less.
7. The following restrictions are imposed on taxi operations on the apron:
  - A-319 ACFT not more than 10 movements per 24 hours;
  - B737-300 ACFT not more than 10 movements per 24 hours;
  - A-320 ACFT not more than 10 movements per 24 hours;
  - B737-400 ACFT not more than 10 movements per 24 hours;
  - A-321 ACFT operation is not allowed;
  - B737-800 ACFT not more than 2 movements per 24 hours.

## AIRCRAFT PARKING

## SANKT-PETERBURG, RUSSIA

### PULKOVO

#### APRON 3 stands:

1. Facing south-east: ACFT shall taxi into/out of stand 301 under tow. ACFT with a wingspan of 42.0 m or less are permitted to taxi under own engines power.
2. Facing south-east: ACFT shall taxi into stands 301A, 301B under tow, taxi out – under own engines power.
3. ACFT shall taxi into/out of stands 302, 302A, 302B, 303, 303A, 303B, 304, 304A, 304B, 305, 306, 307 under own engines power.
4. ACFT shall taxi into stands 301, 301A, 301B (facing north-west), 308, 309, 310, 311, 312, 313, 314, 315, 316, 317, 318, 319 under own engines power, taxi out – under tow.
5. ACFT shall taxi into/out of stand 379 under tow through vacant stand 314 and when stands 315, 379A, 379B are vacant.
6. ACFT shall taxi into/out of stands 379A, 379B under tow through vacant stand 314 and when stand 379 is vacant.
7. ACFT shall taxi into stand 380 under own engines power.  
ACFT shall taxi into stands 381, 382, 383, 384, 385, 386, 387, 388, 388A, 389, 389A under tow.  
ACFT are permitted to taxi under own engines power:
  - into stands 381, 382, 383, 384, 385 through vacant stand with smaller number;
  - into stands 386, 387, 388, 388A, 389 through vacant stand with greater number;
  - into stand 389A through vacant stand 313.ACFT shall taxi out of stands 380, 381, 382, 383, 384, 385, 386, 387, 388, 388A, 389 under own engines power.  
ACFT shall taxi out of stand 389A under tow.  
ACFT are permitted to taxi out of stand 389A under own engines power, when stand 380 is vacant, or when stand 380 is occupied, ACFT with a wingspan of 23.5 m or less and 25.5 m long or less are permitted to taxi out of stand 389A under own engines power.
8. ACFT are permitted to taxi under tow to/from the hangar in the vicinity of stands 383, 384 through stand 383 along the extra taxi guide line under control of aviation personnel:
  - for ACFT with a wingspan of 30.5 m or less and 30.5 m long or less, when stands 383, 384 are vacant;
  - for ACFT with a wingspan of 22.0 m or less and 27.0 m long or less, when stand 383 is vacant.
9. ACFT with a wingspan of 42.0 m or less and 46.2 m long or less are permitted to taxi under tow from stand 313 to the hangar in the vicinity of stand 385 (and in the opposite direction) through vacant stands 380-385 along the extra taxi guide line (10 m south-west of the main taxi guide line) under control of aviation personnel.
10. ACFT are permitted to taxi via taxi route from abeam stand 307 to abeam stand 313 and in the opposite direction:
  - for ACFT with a wingspan of 42.0 m or less - under own engines power;
  - for ACFT with a wingspan of 53.0 m or less - under tow.

#### APRON 4 stands:

1. ACFT shall be parked onto stands 400, 401, 402, 403, 404, 405, 406, 407, 408, 409, 410, 411, 411A, 412, 413, 414, 415, 416, 417, 418, 419, 420, 421, 422, 423, 424 by pushback, taxi out - under tow.

- Taxiing into the stands under own engines power is permitted through vacant stand with smaller number. Taxiing out of these stands under own engines power is permitted through vacant stand with greater number.
2. Through taxiing of HEL with diameter of the main rotor 17.0-21.5 m under own engines power is permitted only along the dotted marking line painted south of the taxi route for airplanes to abeam stand 414.
  3. Through taxiing of ACFT under own engines power is permitted along the main taxi route from TWY B10 to abeam stand 424 and in the opposite direction.
  4. A marked take-off/landing point for HEL of all types is located near ILS area.

#### APRON 5 stands:

1. ACFT shall taxi into/out of stands 500, 501, 502, 503, 504, 505, 506, 507, 508, 509 - under tow. ACFT with length 26.0 m or less, wingspan 25.0 m or less are permitted to taxi into the indicated above stands through vacant stand with smaller number and taxi out of these stands under own engines power.
2. Servicing of ACFT is permitted in daylight hours only.

#### APRON 6 stands:

1. Through taxiing via the apron taxi route is permitted under own engines power for ACFT with a wingspan of 32.0 m or less and 39.5 m long or less.
2. ACFT with a wingspan of 36.0 m or less but above 32.0 m and 39.5 m long or less are permitted to taxi under own engines power on segment of the apron taxi route located between the relevant stands provided that:
  - stands 601, 602 (B, D), 604 (B, D) are vacant or occupied by ACFT of 36.5 m long or less parked facing north;
  - stands 602J, 603J, 604 J are vacant;
  - stand 604F is vacant or occupied by ACFT with a wingspan of 33.0 m or less;
  - stands 605 (A, D), 606D, 607D, 608D, 609D, 610D, 611D are vacant or occupied by ACFT of 31.5 m long or less parked facing south;
  - stand 605C is vacant or occupied by ACFT of 34.0 m long or less.
3. ACFT shall taxi into/out of stands 600, 601, 602 (A, B, C, D, E), 603 (A, B, C, D, E, F, G), 604 (A, B, C, D, E) as follows:
  - facing north: taxi into - under own engines power, taxi out - under tow;
  - facing south: taxi into - under tow, taxi out - under own engines power.
4. ACFT are permitted to taxi into the stands as follows:
  - stands 602 (A, C), when stands 602 (B, D, J) are vacant;
  - stand 602E, when stand 602D is vacant;
  - stands 602 (B, D), when stands 602 (A, C, E, J) are vacant;
  - stands 603 (A, C), when stands 603 (B, D, J) are vacant;
  - stands 603 (E, G), when stands 603 (D, F) are vacant;
  - stands 603 (B, D), when stands 603 (A, C, E, J) are vacant;
  - stand 603F, when stands 603 (E, G) are vacant;
  - stand 604A, when stands 604 (B, F - facing east) are vacant;
  - stands 604 (B, D), when stands 604 (A, C, E, F, J) are vacant;
  - stand 604C, when stands 604 (B, D, F, J) are vacant;
  - stand 604E, when stands 604 (D, F - facing west, J) are vacant.

## AIRCRAFT PARKING

## SANKT-PETERBURG, RUSSIA

## PULKOVO

5. ACFT shall taxi into stand 602J under tow from TWY B11, when stands 602 (A, B, C, D, E) are vacant, taxi out – under tow to TWY B11, when stand 602E is vacant; ACFT shall taxi into stand 603J under tow from TWY B11, when stands 603 (A, B, C, D, E, F) are vacant, taxi out – under tow to TWY B11, when stands 603 (E, F) are vacant.
6. ACFT shall taxi into stand 604F facing east under own engines power, when stands 604 (A, B, C, D, E, J) are vacant; taxi out – by pushback, when stands 604E, 603 (F, G) are vacant.  
ACFT are permitted to taxi out of the stand under own engines power through vacant stand 603F as follows:  
- ACFT with a wingspan of 29.0 m or less and 36.0 m long or less, when stands 603 (E, G) and 604E are vacant;  
- ACFT with a wingspan of 36.0 m or less and 39.5 m long or less, when stands 603 (D, E, G) and 604E are vacant.  
ACFT shall taxi into stand 604F facing west under tow from TWY B11, when stands 604 (B, C, D, E, J) are vacant, taxi out – under own engines power, when stands 604A, 603 (E, F, G) are vacant.
7. ACFT shall taxi into stand 604J facing north-east under own engines power, when stands 604 (B, C, D, E, F) are vacant, taxi out - under tow.  
ACFT shall taxi into stand 604J facing south-west under tow, when stands 604 (B, C, D, E, F) are vacant, taxi out - under own engines power, when stand 604A is vacant.
8. ACFT with a wingspan of 16.0 m or less and 18.0 m long or less are permitted to taxi under own engines power as follows:  
- into stand 604A through vacant stand 604C;  
- into stand 604C through vacant stand 604A or vacant stand 604E;  
- into stand 604E through vacant stand 604C;  
- into stand 603A through vacant stand 603C;  
- into stand 603C through vacant stand 603A or vacant stand 603E;  
- into stand 603E through vacant stand 603C or vacant stand 603G;  
- into stand 603G through vacant stand 603E and when stand 603J is vacant.
9. Stand 605:  
- ACFT shall taxi into stands 605 (A, C, D) under own engines power, taxi out – under tow; ACFT shall taxi into/out of stand 605B – under own engines power;  
- ACFT are permitted to taxi under own engines power: into stands 605 (A, D), when stands 605 (B, C) are vacant; into stand 605B, when stands 605 (A, C, D) and stands 606 (A, B, D) are vacant; into stand 605C, when stands 605 (A, B, D) and 606 (A, B, D) are vacant;  
- ACFT are permitted to taxi into/out of stand 605C under tow, only when stands 606 (A, D) are vacant.
10. Simultaneous parking of ACFT is permitted on stands 606 (A, C), 607 (A, C), 608 (A, C), 609 (A, C), 610 (A, C), 611 (A, C), 612 (A, C), when stands 606 (B, D), 607 (B, D), 608 (B, D), 609 (B, D), 610 (B, D), 611 (B, D), 612D are vacant respectively. In all other cases, only one ACFT is permitted to be parked on (taxi through) a vacant stand.
11. ACFT are permitted to taxi:  
- into stands 606A (when stand 605D is vacant), 607A, 608A, 609A, 610A, 611A, 612A under own engines power for parking facing north through vacant stands 606C, 607C, 608C, 609C, 610C, 611C, 612C respectively, taxi out - under own engines power;
- into stands 606A, 607A, 608A, 609A, 610A, 611A, 612A under own engines power for parking facing south, taxi out – by pushback.
12. ACFT are permitted to taxi into stands 606B, 607B, 608B, 609B, 610B, 611B:  
- for parking facing south-east - under own engines power; taxi out - through vacant stands 607D, 608D, 609D, 610D, 611D, 612D respectively or by pushback;  
- for parking facing north-west - under own engines power through vacant stands 607D, 608D, 609D, 610D, 611D, 612D respectively or by pushback, taxi out – under own engines power.
13. Procedure of ACFT parking onto stands 606D, 607D, 608D, 609D, 610D, 611D, 612D facing south: taxi in - under own engines power; taxi out – by pushback. Procedure of ACFT parking onto stands 607D, 608D facing north: taxi in – under tow, taxi out – under own engines power.  
Procedure of ACFT parking onto stands 606D, 609D, 610D, 611D, 612D facing north: taxi in/taxi out – under tow.
14. Procedure of ACFT parking onto stands 606C, 607C, 608C, 609C, 610C, 611C, 612C:  
- facing south: taxi in – under own engines power; taxi out – only for ACFT with a wingspan of 14.0 m or less and 18.0 m long or less through vacant stands 606A, 607A, 608A, 609A, 610A, 611A, 612A respectively or by pushback;  
- facing north: taxi in – by pushback only. Taxi out of stands 606C, 607C, 608C – under own engines power, out of stands 609C, 610C, 611C, 612C – under own engines power only for ACFT 18.0 m long or less, or under tow without limitations.

**APRON 7 stands:**

1. Stand 700:  
- ACFT shall taxi into the stand under own engines power, when stands 701, 702, 703, 704 are vacant, taxi out – under tow;  
- it is permitted to park An-124-100 ACFT onto the stand with nose landing gear on stop line NR 1 – for loading/unloading operations using the door in the front part of the ACFT, or in alignment with the T-shaped ACFT stand marking - for loading/unloading operations using the door in the rear part of the ACFT.
2. Stand 701: ACFT shall taxi in under own engines power, when stands 700, 702 are vacant, taxi out – under tow.
3. Stand 702:  
- ACFT shall taxi in under own engines power, when stands 700, 701, 703 are vacant, taxi out – under tow;  
- ACFT with length 39.5 m or less and wingspan 36.0 m or less shall taxi in facing north-east under own engines power through vacant stand 704, when stands 700, 701, 703, 705 are vacant; taxi out - under own engines power;  
- ACFT with length 44.5 m or less and wingspan 36.0 m or less shall taxi in under tow facing north-east, when stands 700, 701, 703 are vacant; taxi out – under own engines power.
4. Stand 703: ACFT shall taxi in under own engines power, when stands 700, 702 are vacant and stand 704 is occupied by ACFT with wingspan 29.7 m or less, taxi out – under tow.
5. Stand 704:  
- ACFT shall taxi in under own engines power, provided stand 700 is vacant and taxi out – under tow;

**AIRCRAFT PARKING**

**SANKT-PETERBURG, RUSSIA  
PULKOVO**

- ACFT with length 74.0 m or less and wingspan 65.0 m or less shall taxi in under own engines power, when stands 700, 703, 705 are vacant; taxi out – under tow.
- 6. Stand 705:
  - ACFT shall taxi in under own engines power, when stand 706 is vacant and stand 704 is occupied by ACFT with wingspan 29.7 m or less; taxi out – under tow.
  - ACFT shall be parked onto the stand under tow, when stands 704, 706 are occupied by ACFT with wingspan 29.7 m or less; taxi out – under tow.
- 7. Stand 706:
  - ACFT shall taxi in/taxi out under tow;
  - parking of ACFT with length 74.0 m or less and wingspan 65.0 m or less is permitted, provided stands 705, 707 are vacant, taxi out – under tow.
- 8. Stand 707:
  - ACFT shall taxi in under own engines power, when stand 706 is vacant and stand 708 is occupied by ACFT with wingspan 36.0 m or less, taxi out – under tow;
  - ACFT shall be parked onto the stand under tow, when stand 706 is occupied by ACFT with wingspan 29.7 m or less and stand 708 is occupied by ACFT with wingspan 36.0 m or less, taxi out – under tow.
- 9. Stand 708:
  - ACFT shall taxi in under own engines power, taxi out – under tow;
  - ACFT with length 74.0 m or less and wingspan 65.0 m or less shall taxi in under own engines power, when stands 707, 709 are vacant; taxi out – under tow.
- 10. Stand 709: ACFT shall taxi in under own engines power, when stand 710 is vacant and stand 708 is occupied by ACFT with wingspan 36.0 m or less; taxi out – under tow.
- 11. Stand 710: ACFT shall taxi in under own engines power, when stands 709, 711 are vacant; taxi out – under tow.
- 12. Stand 711: ACFT shall taxi in under own engines power, when stand 710 is vacant, taxi out – under tow.