

AERODROME CHART ICAO

CAGLIARI / ELMAS

L I E E

39°14'50" N 009°03'22" E

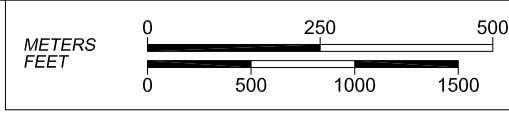

AD ELEV 11
APRON ELEV 13

Bearings are magnetic
Distances in metres
Elevation in ft AMSL
Coordinates WGS84

TWR	120.605	122.100
GND	125.430	
ATIS	127.055	

RWY	QFU	THR	bearing strength
14	137°	N 39°15'39.02" E 009°02'36.33"	PCN 102/F/A/X/T
32	317°	N 39°14'31.48" E 009°03'54.63"	

VAR +3° E-2022.1
Annual rate of change 7' E

CHANGE: TWY H WIDTH, MAG VAR AND CHART UPDATED

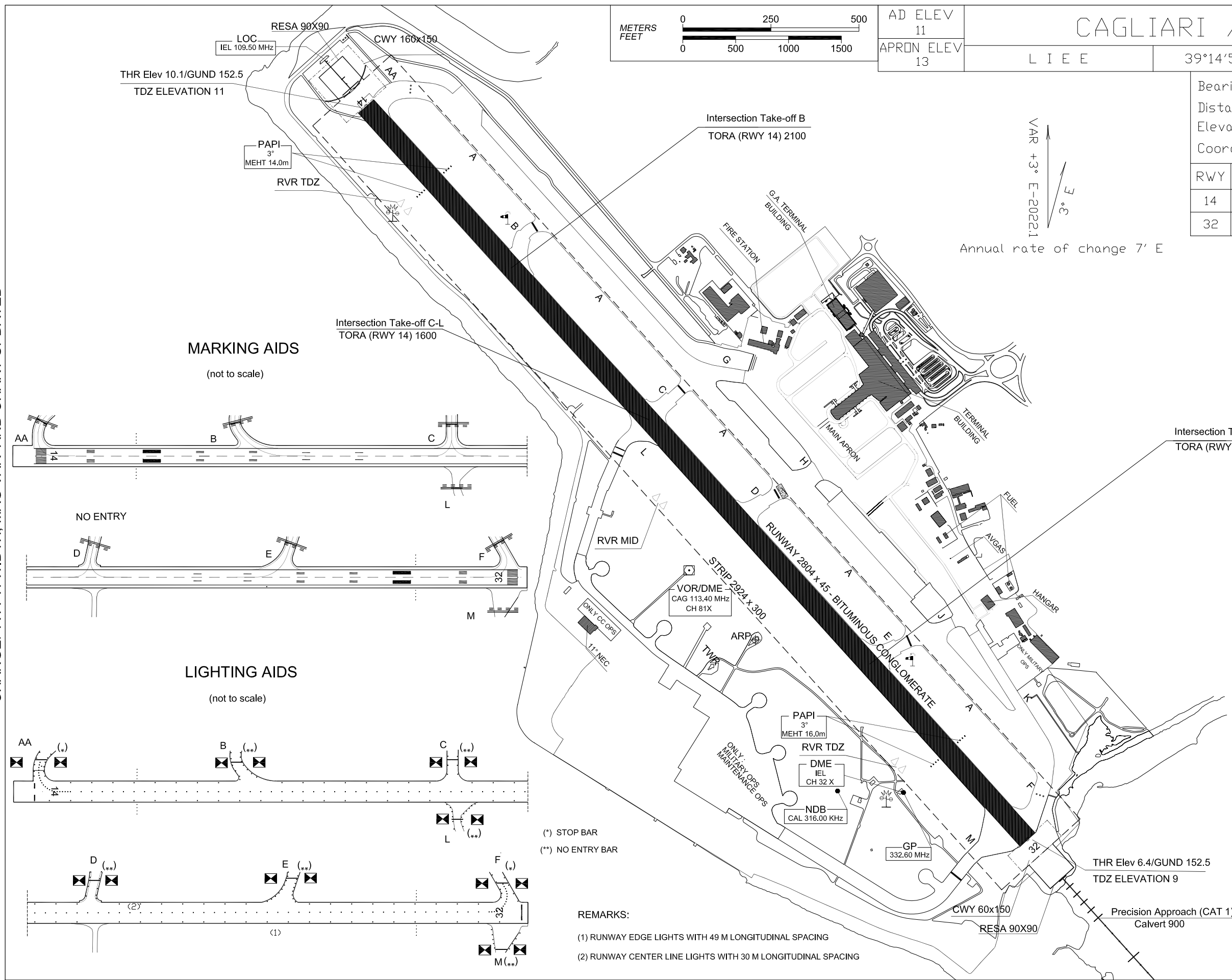

MARKING AIDS
(not to scale)

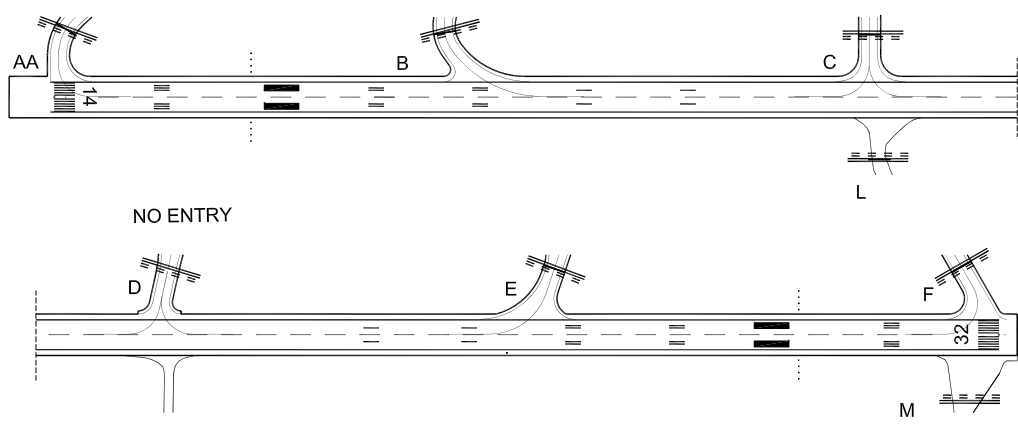

LIGHTING AIDS
(not to scale)

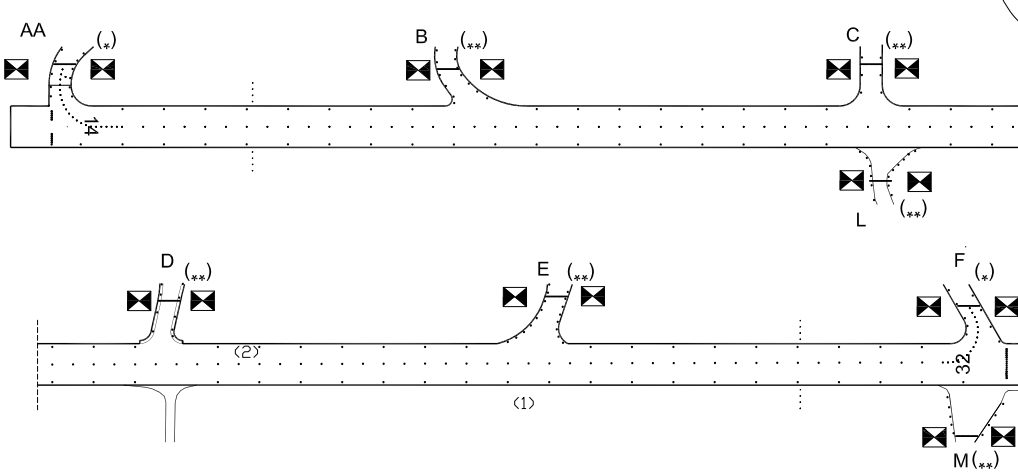

(*) STOP BAR
(**) NO ENTRY BAR

REMARKS:
(1) RUNWAY EDGE LIGHTS WITH 49 M LONGITUDINAL SPACING
(2) RUNWAY CENTER LINE LIGHTS WITH 30 M LONGITUDINAL SPACING

TWY IDENT	WIDTH	BEARING STRENGTH
AA	23	PCN 135/F/A/W/T
A	44	PCN 145/F/B/W/T
B	23	PCN 131/F/A/W/T
C	24	PCN 87/F/C/W/T
D	23	PCN 189/F/B/W/T
E	23	PCN 71/F/C/W/T
F	23	PCN 200/F/A/W/T
G	28	PCN 81/F/A/W/T
H	33	PCN 153/F/A/W/T
J	23	PCN 153/F/C/W/T
K	23	PCN 150/F/A/W/T
L	17	PCN 187/F/B/W/T
M	23	PCN 186/F/A/W/T

Data provided by SOGAER